



Barrier washers, Evolution range

WSB5180H, WSB5250H, WSB5350H

Features and benefits

- Pass-through construction to offer the best ergonomics in barrier installations
- External doors with vertical hinges and 175° opening, easy to handle and reversible
- Automatic drum positioning and locking for the loading and unloading operation, offering the best ergonomics and safety for the operators
- Large inner drum doors to make loading and unloading operation easiest than ever
- Compass Pro® controller with a user friendly interface to make the operator's life easy allowing 40 factory and 15 customised wash programs
- Compatible with up to 13 detergent signals as standard to stand the most complicated wash programs
- Suspended construction allowing a 350G extraction to save energy during the drying process
- Feature the Power Balance from Electrolux that ensures the best extraction whatever the loading conditions are
- New lifters for a better wash result
- Easy program customization via the LPM software from Electrolux

Main options

- End of cycle alarm to give operators the best information
- Double display to better handle the process on the clean side of the laundry
- 4 compartments soap box to use liquid or powder detergents
- Stainless steel body to better stand the aggressive environments
- Integrated weighing system to optimise the loading operations
- 3rd water inlet valve to use soft water



Images shown are a representation of the product only and variations may occur.

| Main specifications | | | | WSB5180H | | | WSB5250H | | | WSB5350H | | |
|--------------------------------------|---------------------|-------|-------|----------|-------|-----|----------|-------|-----|----------|-------|------|
| Max. capacity | filling factor 1:11 | kg/lb | | 18/40 | | | 25/55 | | | 35/77 | | |
| | filling factor 1:10 | kg/lb | | 20/44 | | | 27/60 | | | 38/84 | | |
| Drum, | volume | litre | | 180 | | | 250 | | | 350 | | |
| | diameter | ø mm | | 770 | | | 770 | | | 770 | | |
| Extraction | | rpm | | 910 | | | 910 | | | 910 | | |
| G-factor | | | | 350 | | | 350 | | | 350 | | |
| Heating alternatives, 380-400V | electricity | kW | | 13.5 | | | 18 | | | 27 | | |
| | steam | kg/h | | 9 | | | 12 | | | 16 | | |
| | gas | Btu/h | | 136600 | | | 136600 | | | 136600 | | |
| Consumption data "Cotton eco" | | | | El | Steam | Gas | El | Steam | Gas | El | Steam | Gas |
| Water consumption (cold) | | | litre | 165 | 165 | 185 | 230 | 230 | 250 | 322 | 322 | 342 |
| Energy consumption (motor/heating) | | | kWh | N/A | 0.5 | 0.7 | 6 | 0.6 | 0.8 | 9.2 | 0.7 | 0.95 |
| Steam consumption | | | kg | - | 9 | - | - | 12 | - | - | 16 | - |
| 1 wash, 2 rinses. | | | | | | | | | | | | |

| Electrical connections | | | | | |
|------------------------|--------------|-------|------------------|----------------|--------------------|
| Heating alternative | Main voltage | Hz | Heating power kW | Total power kW | Recommended fuse A |
| WSB5180H | | | | | |
| Electric heated | 400-415V 3 ~ | 50/60 | 13.5 | 15 | 3 x 32 |
| Steam heated | 400-415V 3 ~ | 50/60 | - | 6 | 3 x 16 |
| Gas heated | 400-415V 3 ~ | 50/60 | 40 | 6.3 | 3 x 16 |
| WSB5250H | | | | | |
| Electric heated | 400-415V 3 ~ | 50/60 | 18 | 19.5 | 3 x 40 |
| Steam heated | 400-415V 3 ~ | 50/60 | - | 6.2 | 3 x 16 |
| Gas heated | 400-415V 3 ~ | 50/60 | 40 | 6.5 | 3 x 16 |
| WSB5350H | | | | | |
| Electric heated | 400-415V 3 ~ | 50/60 | 27 | 28.8 | 3 x 50 |
| Steam heated | 400-415V 3 ~ | 50/60 | - | 6.4 | 3 x 16 |
| Gas heated | 400-415V 3 ~ | 50/60 | 40 | 6.7 | 3 x 16 |

| Water, steam, gas and air connections | | WSB5180H | WSB5250H | WSB5350H |
|---------------------------------------|--------------------------|----------|----------|----------|
| Water valves | DN | 20 | 20 | 20 |
| Water pressure | kPa | 50-300 | 50-300 | 50-300 |
| Capacity at 250 kPa | l/min | 70 | 70 | 70 |
| Drain valve | ø mm | 75 | 75 | 75 |
| Draining capacity | l/min | 240 | 240 | 240 |
| Steam valve | DN | 20 | 20 | 20 |
| Steam pressure | kPa | 100-600 | 100-600 | 100-600 |
| Gas valve | DN | 20 | 20 | 20 |
| Gas evacuation | ø mm | 125 | 125 | 125 |
| Floor requirements | | | | |
| Frequency of the dynamic force | Hz | 15.2 | 15.2 | 15.2 |
| Sound levels | | | | |
| Airborne sound level | dB(A) | 72 | 72 | 72 |
| Heat emission | | | | |
| % of installed power, max | | 3 | 3 | 3 |
| Shipping data | | | | |
| | net, kg | 670 | 710 | 770 |
| Shipping volume | m ³ | 2.34 | 2.77 | 3.38 |
| Dimensions in mm | | | | |
| A Width | | 895 | 1050 | 1270 |
| B Depth | | 1040 | 1050 | 1060 |
| C Height | | 1620 | 1620 | 1620 |
| D | | 850 | 850 | 850 |
| E | | 215 | 215 | 215 |
| F | | 360 | 440 | 550 |
| G | | 780 | 780 | 780 |
| 1 Electrical connection | 7 Liquid detergent inlet | | | |
| 2 Cold hard water | 8 Detergent container | | | |
| 3 Hot water | 9 Loading door | | | |
| 4 Cold soft water | 10 Control panel | | | |
| 5 Steam connection | 11 Air vent connection | | | |
| 6 Drain | | | | |

Other voltages available, see installation manual.
Average data. Crated weight/shipping volume depends on configuration.
Please contact logistics for exact measures.
Art. No. 438919534EN/2015.01.14
We reserve the right to alter specifications without notice.

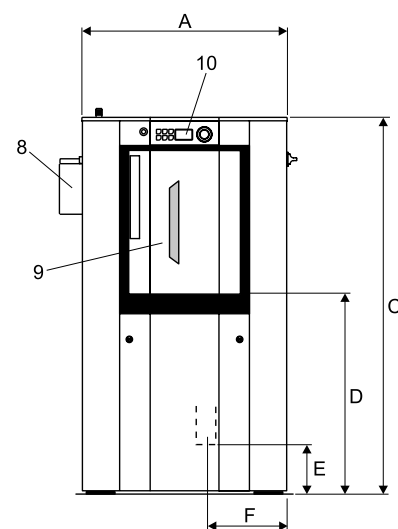

Front view

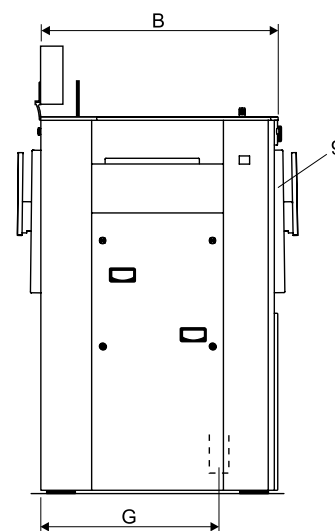

Side view

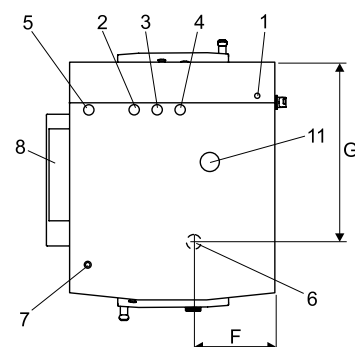

Top view



Electrolux
Authorized
Partner



Unit 3 / 41 Biscayne Way, Jandakot, WA 6164
Ph : (08) 9414 9474 Fax : (08) 6210 5961
Service : 0411 883 346 / 0400 246 352
Sales : 0406 659 429/ sales@comls.com.au
Web site : www.comls.com.au