

Electrolux Authorized Partner



Tumble dryer T5675

Features and benefits

- Axial airflow and tight construction gives low energy consumption
- High productivity - 2 full loads per hour
- Large door opening for easy loading and unloading
- Easy and ergonomic access to the lint screen
- Excellent water evaporation efficiency per kWh
- The coin version with Ecopower to avoid over drying of the garments and get a lower energy consumption
- With Compass Pro program control
 - Large and clear display with control knob for easy program selection
 - Easy access with user-friendly interface
 - Language selection
 - Drying program packages optimized for Economy, Care and Time
 - Service program for adjustment of parameters
 - USB connection

Main options

- Stainless steel front
- Stainless steel drum
- Residual Moisture Control - RMC
- Connection to booking- /payment- system or coin meter
- Reversing drum
- Emergency stop button
- Supply disconnecter
- Frequency controlled motor

Accessories

- Fresh air intake
- Exhaust on top
- Insert for drying special equipment



Images shown are a representation of the product only and variations may occur.

Main specifications			T5675			
Rated capacity, filling factor 1:18	kg/lb		37.5/82.7			
filling factor 1:22	kg/lb		30.6/67.5			
Drum volume	litre		675			
Drum diameter	mm		913			
Heating alternatives						
electric	kW		32/40			
gas	BTU/h (kW)		14 3400 (42)			
steam at 600-700 kPa	kW		46			
Consumption data*			32 kW	40 kW	Gas	Steam
Total time at 30.6 kg	min		28	23	23	22
Energy consumption at 30.6 kg	kWh		15.10	15.08	16.42	19.27
Evaporation	g/min		544	676	653	700
Energy kWh/litre water evaporated	kWh/l		0.98	0.98	1.07	1.26

* At rated capacity 100% cotton load at 50% initial moisture dried to 0%.

Certified in accordance with ISO 9001 and ISO 14001 and approved IP X4

Electrical connections*

Heating alternative	Main voltage	Hz	Heating power kW	Total power kW	Recommended fuse A
Electric heated	220-240V 3 ~	50/60	32.0/40.0	34.4/42.4	100/125
	380-415V 3 ~	50/60	32.0/40.0	24.5/42.5	50/63
Gas heated / Steam heated	220-240V 1 ~	50/60	-	2.0	10
	220-240V 3 ~	50/60	-	2.4	10
	380-415V 3 ~	50/60	-	2.5	10

Steam, gas and air connections

T5675		
Steam	ISO 7/1-R	1"
Steam pressure	kPa	100-1000
Steam consumption	kg/h	65
Condensate	ISO 7/1-R	1"
Gas	NG/PG	ISO 7/1-R
Gas pressure	Natural gas	Pa
		2000
	Propane	mbar
		20
Air outlet	Pa	2800-3700
		28-37
	ø mm	200
Maximum air flow:		
Electric 50 Hz / 60 Hz	m³/h	1140 / 1140
	m³/h	1140 / 1140
	m³/h	1380 / 1380
Maximum static back pressure:		
Electric 50 Hz / 60 Hz	Pa	270 / 800
	Pa	410 / 800
	Pa	900 / 1100

Sound levels

Airborne sound level dB(A)	<70
----------------------------	-----

Heat emission

% of installed power, max	15
---------------------------	----

Shipping data**

Shipping volume	net, kg	283
	crated, m³	3.25

Dimensions in mm

A	Width	961
B(a)	Depth	1560
B(b)	Depth	1640
C	Height	1857
D		660
E		720
F		170
G		1490
H		200
I		180
J		1560
K		50
L		480
M		580
N		805

- 1 Control panel
- 2 Door opening ø 810 mm
- 3 Electrical connection
- 4 Gas connection
- 5 Exhaust connection
- 6 Condensate connection
- 7 Steam connection
- 8 Lint screen

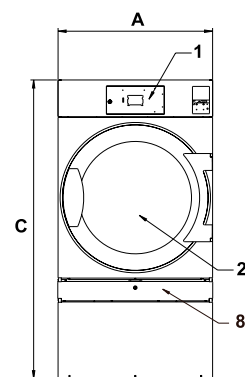

Front

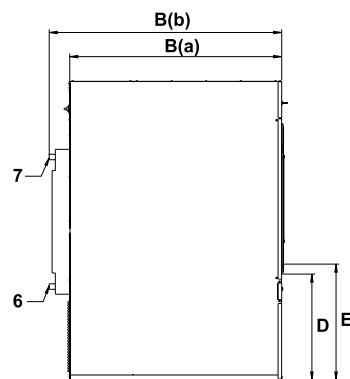

Left side

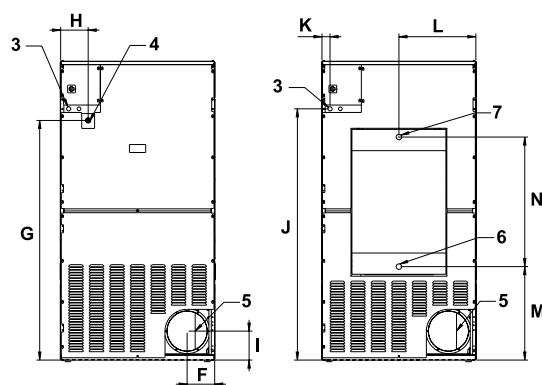

El, gas

Steam

Rear side

* Other voltages available, see installation manual.

** Average data. Crated weight/shipping volume depends on configuration. Please contact logistics for exact measures.



Unit 3 / 41 Biscayne Way, Jandakot, WA 6164
 Ph : (08) 9414 9474 Fax : (08) 6210 5961
 Service : 0411 883 346 / 0400 246 352
 Sales : 0406 659 429 / sales@comls.com.au
 Web site : www.comls.com.au