

# Electrolux Authorized Partner



## Tumble dryer T5350

### Features and benefits

- High productivity – 2 full loads per hour
- Low energy consumption for optimal efficiency
- Large door opening for easy loading and unloading
- Large selfcleaning lint screen for easy maintenance
- Reversible door hanging for a convenient laundry flow
- Easy access to vital parts from front and rear for simple servicing
- With Compass Pro program control
  - Large display and one control knob for easy program selection
  - Language selection
  - Quick selection and option buttons for the most frequently used drying programs and options
  - Drying program packages optimized for Economy, Care and Time and option buttons for selection of dryness
  - Service program for adjustment of parameters
  - USB connection
- The coin version with Ecopower to avoid over drying of the garments and get a lower energy consumption

### Main options

- Stainless steel front
- Stainless steel drum
- Residual Moisture Control – RMC
- Reversing drum
- Payment: coinmeter with Ecopower, chipcard reader, CP connection
- Special versions (dryer + option package): Lagoon® variant includes stainless steel front, stainless steel drum, RMC and reversing drum
- Fresh air intake
- Supply disconnecter
- CMIS (Certus Management Information System)



Images shown are a representation of the product only and variations may occur.

Main specifications			T5350			
Rated capacity, filling factor 1:18 filling factor 1:22  Drum volume Drum diameter Heating, electric gas steam at 800 kPa  <b>Consumption data</b>  Total time full load Energy consumption full load Evaporation Energy kWh/litre water evaporated	kg/lb		19.4/42.8			
	kg/lb		15.5/34.2			
	litre		349			
	mm		760			
	kW		13.5/18			
	BTU/h (kW)		71700 (21)			
			25			
			13.5 kW	18 kW	Gas	Steam
			38	27	24	22
		8.2	7.7	8.4	11.7	
		211	289	342	359	
		1.02	0.99	1.03	1.48	
At rated capacity 100% cotton load at 50% initial moisture dried to 0%.						

At rated capacity 100% cotton load at 50% initial moisture dried to 0%.

Certified in accordance with ISO 9001 and ISO 14001 and approved IP X4.

Electrical connections					
Heating alternative	Main voltage		Heating power kW	Total power kW	Recommended fuse A
		Hz			
Electric heated	220-240V 3 ~	50/60	13.5/18.0	14.6/19.1	50
	380-415V 3N ~	50/60	13.5/18.0	14.6/19.1	25/35
	440V 3 ~	60	13.5/18.0	14.6/19.1	25/35
	480V 3 ~	60	13.5/18.0	14.6/19.1	20/25
Gas heated/ Steam heated	220-240V 3 ~	50/60	13.5/18.0	1.1	10
	380-415V 3N ~	50/60	13.5/18.0	1.1	10
	440V 3 ~	60	13.5/18.0	1.1	10
	480V 3 ~	60	13.5/18.0	1.1	10

Steam, gas and air connections			T5350
Steam	ISO 7/1-R		1"
Steam pressure		kPa	100-1000
Steam consumption		kg/h	65
Condensate	ISO 7/1-R		1"
Gas	ISO 7/1-R		1/2"
Gas pressure	Natural gas	Pa	2000
		mbar	20
	Propane	Pa	2800-5000
		mbar	28-50
Air outlet		ø mm	200
Evacuated air,	el 13.5 kW	m³/h	600
	el 18 kW		1000
	gas 21 kW		1000
	steam		1000
Pressure drop	el 13.5 kW	Max. Pa	520
	gas 13.5 kW		520
	el 18 kW/gas 21 kW/steam		270
Sound levels			
Airborne sound level		dB(A)	<70
Heat emission			
% of installed power, max			15
Shipping data			
Weight		net, kg	177
Shipping volume		crated, m³	1.96
Dimensions in mm			
A	Width		790
B(a)	Depth, el and gas		1177
B(b)	Depth, steam		1344
C	Height		1770
D			785
E			840
F			108
G			66
H			278
I			171
J			172
K			395
L			605
M			747
1 Operating panel			
2 Door opening ø 580 mm			
3 Electrical connection			
4 Gas connection			
5 Exhaust connection			
6 Steam: in			
7 Steam: out			

Other voltages available, see installation manual.  
Average data. Crated weight/shipping volume depends on configuration.  
Please contact logistics for exact measures.  
Art. No. 438919517EN/2015.01.14  
We reserve the right to alter specifications without notice.

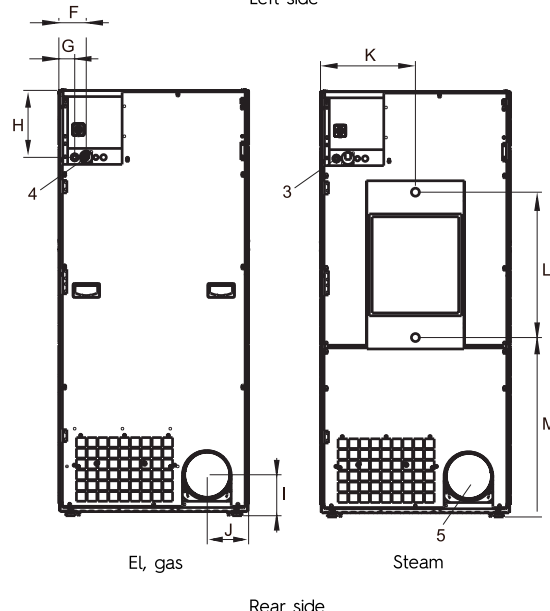
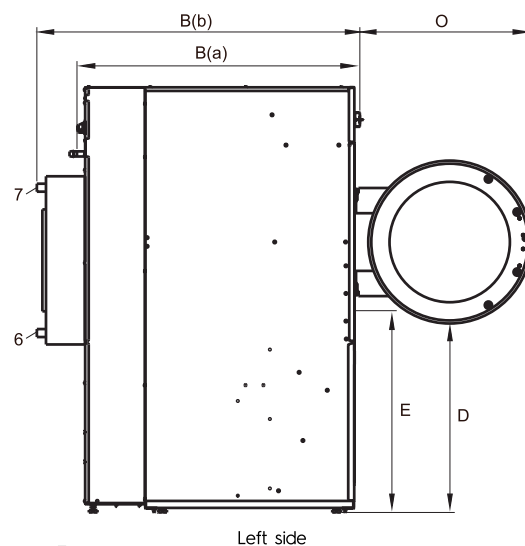
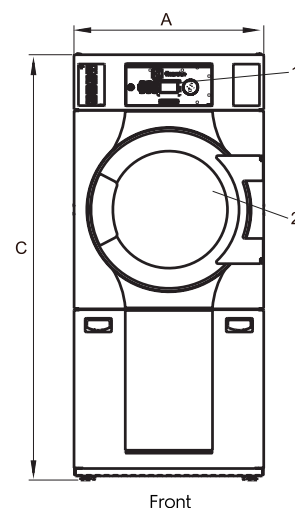

**Electrolux**  
**Authorized**  
**Partner**



Unit 3 / 41 Biscayne Way, Jandakot, WA 6164  
Ph : (08) 9414 9474 Fax : (08) 6210 5961  
Service : 0411 883 346 / 0400 246 352  
Sales : 0406 659 429/ [sales@comls.com.au](mailto:sales@comls.com.au)  
Web site : [www.comls.com.au](http://www.comls.com.au)